

Digitax HD M75X Compact Braking Resistor Installation Sheet

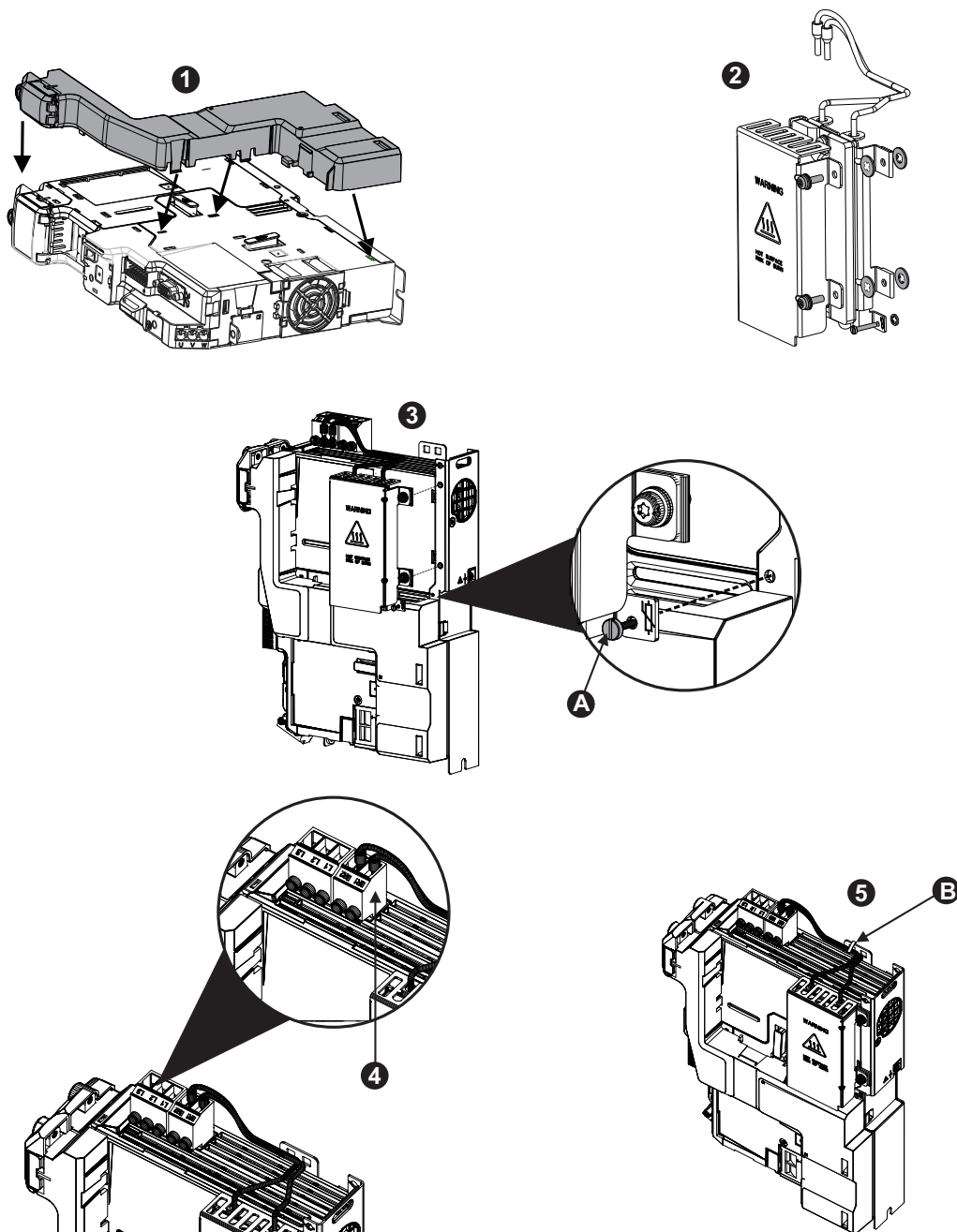

The compact braking resistor must only be used with the Digitax HD M75X drive range.



1. Install SI-option module mounting kit (9500-1055).
2. Ensure four M3 washers and one M2 washer are present on the brake resistor assembly.
3. Secure the compact brake resistor assembly to the metal side panel using two M3 mounting screws. Attach and secure the M2 screw (A). Observe the following maximum torque:
M3 screws - 1 N m (8.9 lb in).
M2 screw - 0.3 N m (2.7 lb in).
4. Connect the brake resistor cables to terminals BR1 and BR2 on the brake terminal connector.
5. Secure cables to bracket (B).



The M2 screw forms part of the thermal protection system for the compact brake resistor and therefore **MUST** be fitted. Maximum torque 0.3 N m (2.7 lb in).



0478-0445-02